

368400.0000

368300.0000

368200.0000

6791800.0000

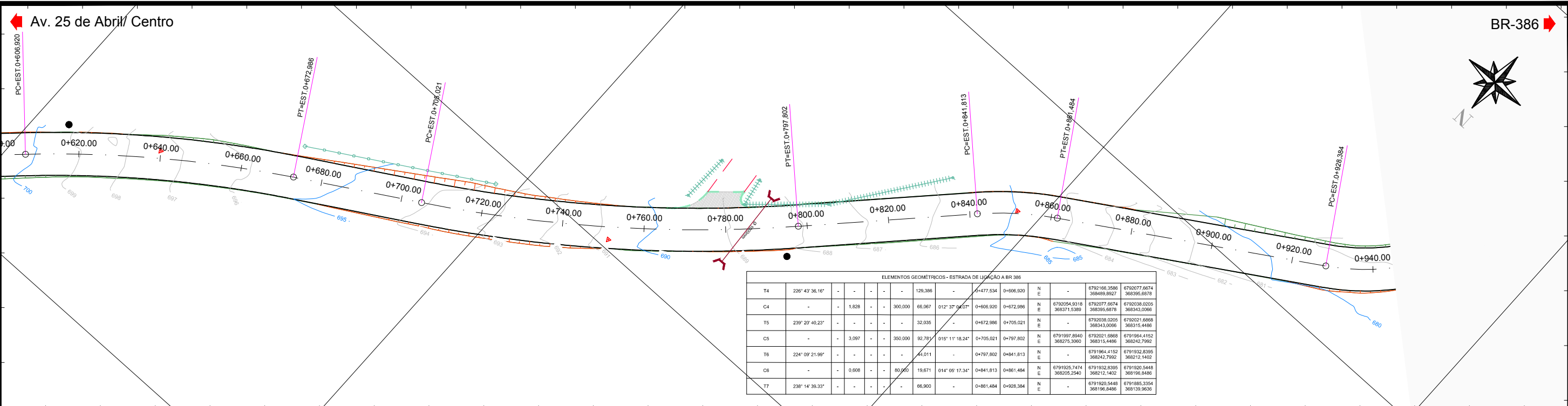

368300.0000

368200.0000

368100.0000

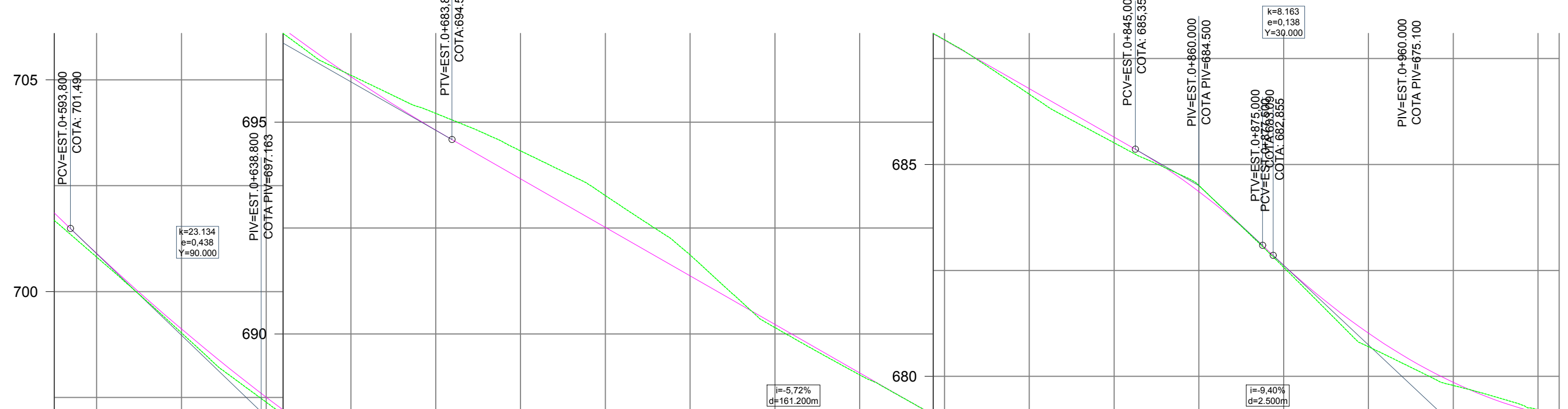

KM	COTAS TERRENO	COTAS PROJETO
0+600.00	700,816	700,816
0+620.00	699,027	699,027
0+640.00	697,389	697,389
0+660.00	696,106	696,106
0+680.00	695,207	695,207
0+700.00	694,322	694,322
0+720.00	693,266	693,266
0+740.00	691,866	691,866
0+760.00	690,151	690,151
0+780.00	689,034	689,034
0+800.00	687,945	687,945
0+820.00	686,659	686,659
0+840.00	685,512	685,512
0+860.00	684,506	684,506
0+880.00	682,575	682,575
0+900.00	680,699	680,699
0+920.00	679,785	679,785
0+940.00	679,213	679,213
0+945.00	679,094	679,094



MUNICÍPIO DE FONTOURA XAVIER
 ESTRADA DE LIGAÇÃO A BR-386
 KM 0+235 AO KM 1+462,47

MUNICÍPIO

RESP. TÉCNICO

PROJETO GEOMÉTRICO

EXTENSÃO: 1.227,47 m	ESC. HORIZONTAL: 1:1000	DATA: maio/21
ÁREA: 8.637,29 m²	ESC. VERTICAL: 1:100	PRANCHA: 2